

Niiza Campus Map and Access Guide

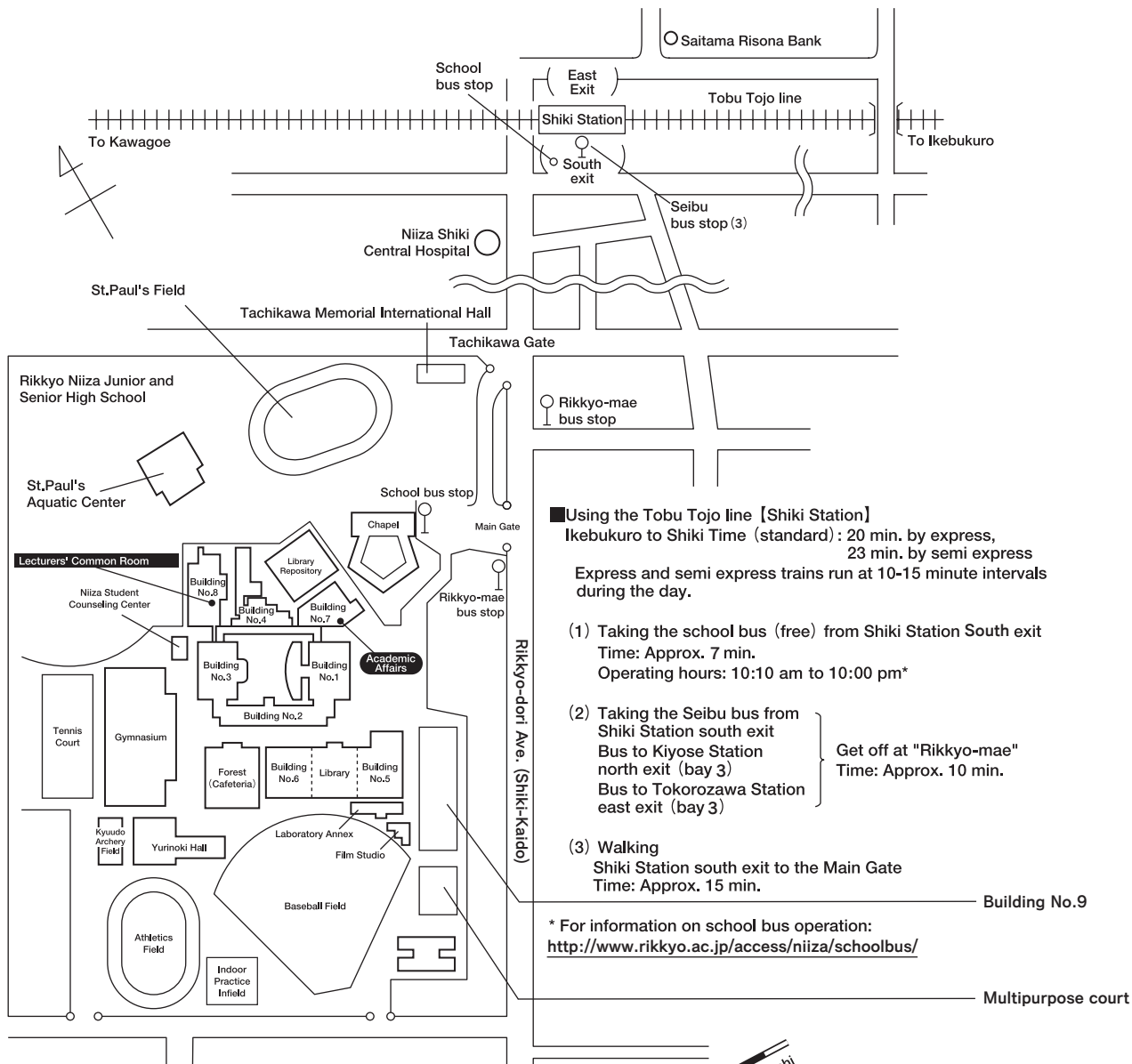

Using the JR Musashino line [Niiza Station]

- (1) Taking the school bus (free) from Niiza Station south exit
 Time: Approx. 10 min.
 Operating hours: 7:30 am to 10:00 pm* (near Seibu bus bay 3)
- (2) Taking the Seibu bus from Niiza Station south exit
 Bus to Shiki Station south exit (via Kitano Iriguchi) (bay 1)
 Get off at "Rikkyo-mae"
 Time: Approx. 10 min.
- (3) Walking
 Niiza Station to the Main Gate
 Time: Approx. 25 min.

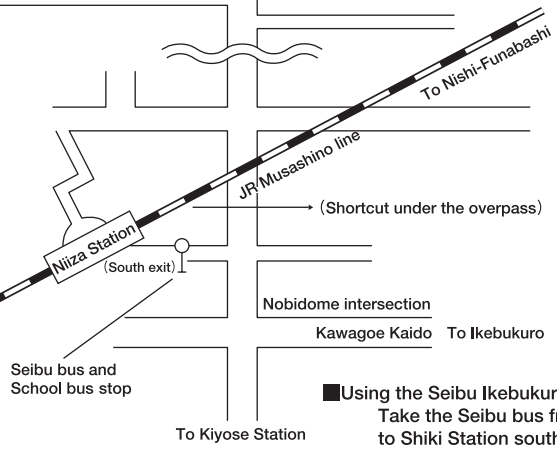

Using the Seibu Ikebukuro line [Kiyose Station]

Take the Seibu bus from Kiyose Station north exit to Shiki Station south exit (bay 2) and get off at "Rikkyo-mae". Time: approx. 30 minutes.

Niiza Campus Classroom Guide

Key to classroom numbers



"N" denotes Niiza.
Building Number
Floor
Room Number
("T" denotes Gymnasium)

1st floor

Building No.8

1st basement

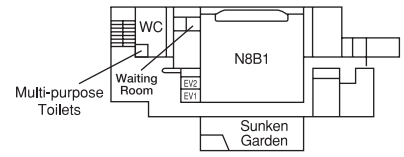

Building No.9

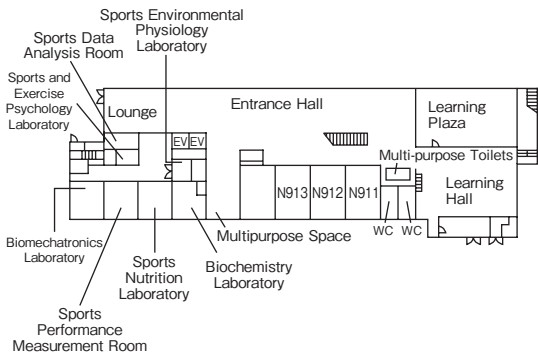

2nd floor

Building No.2

Building No.3

Building No.8

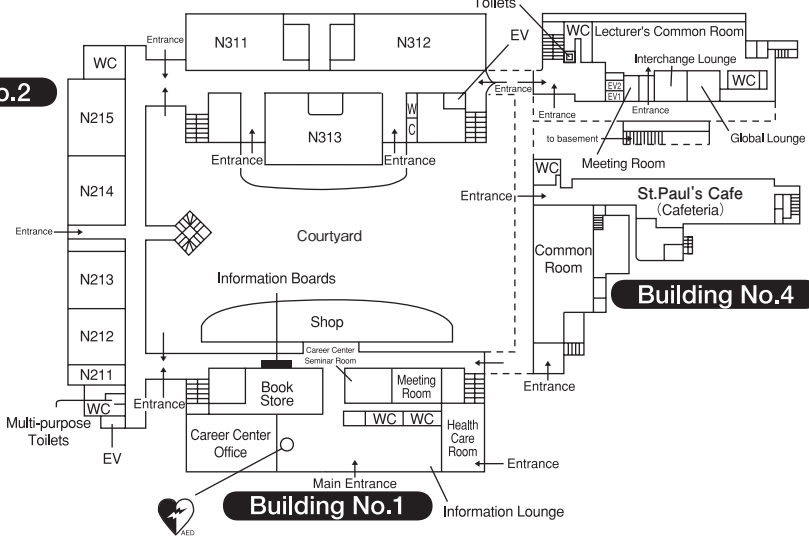

Building No.3

Building No.8

Building No.2

Building No.6

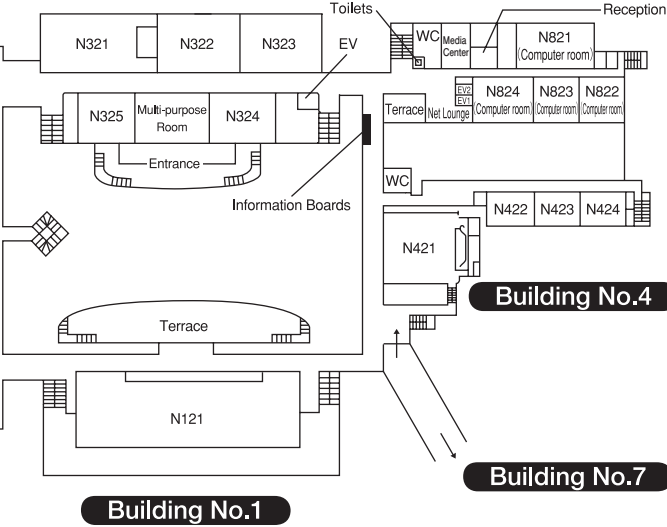

Building No.9

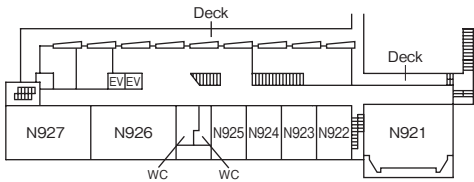

Niiza Campus Classroom Guide

3rd floor

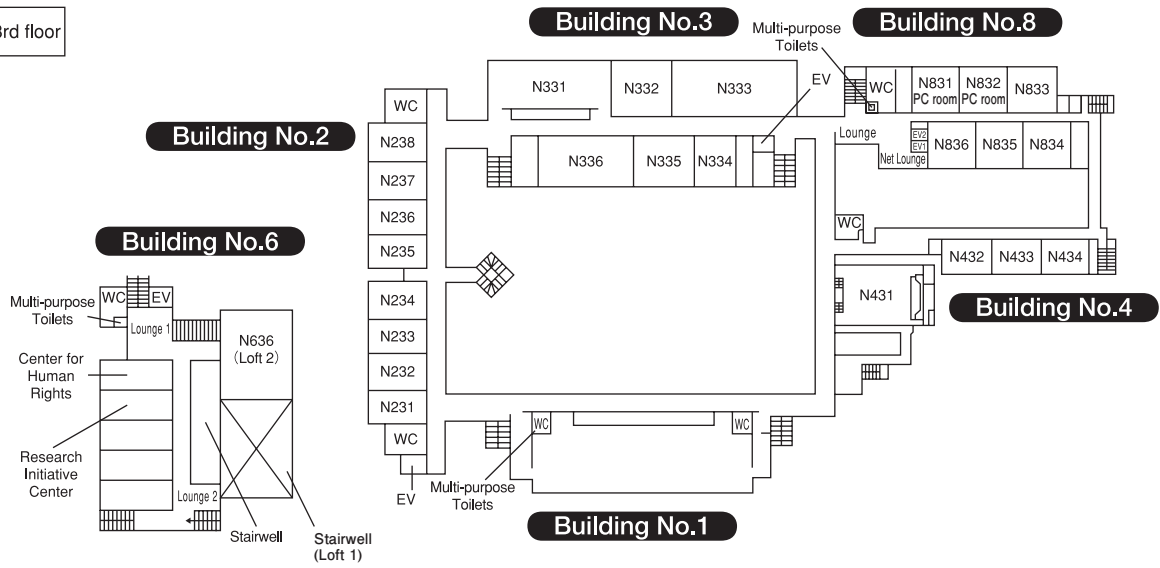

Building No.9

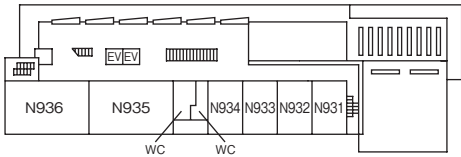

4th floor

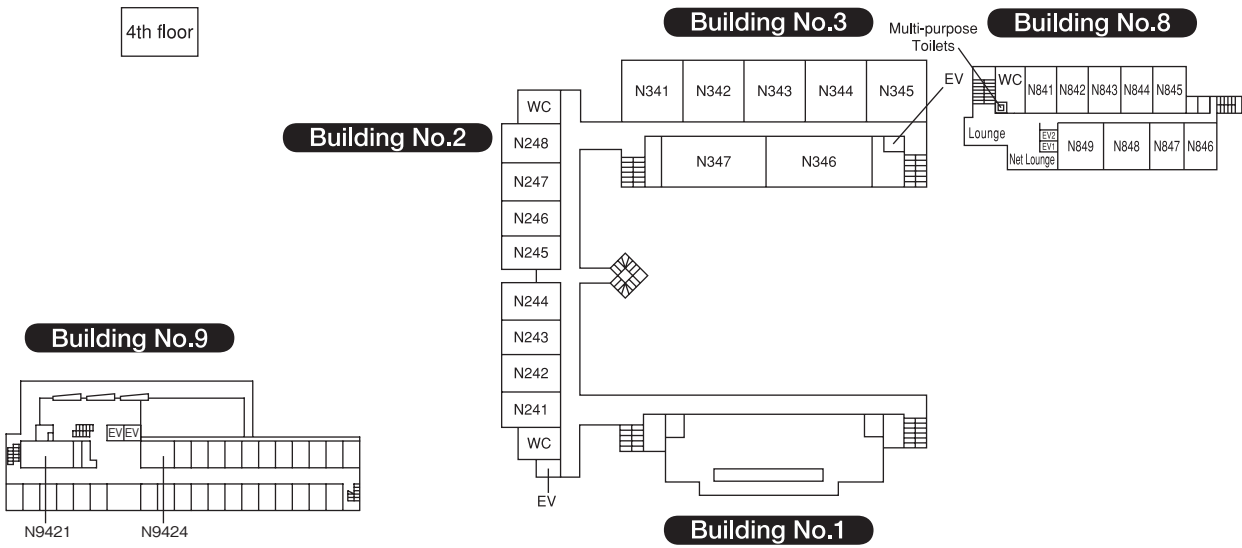

5th floor

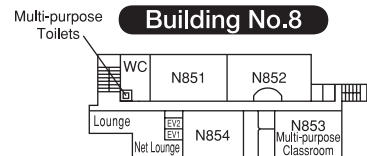

Niiza Campus Gymnasium

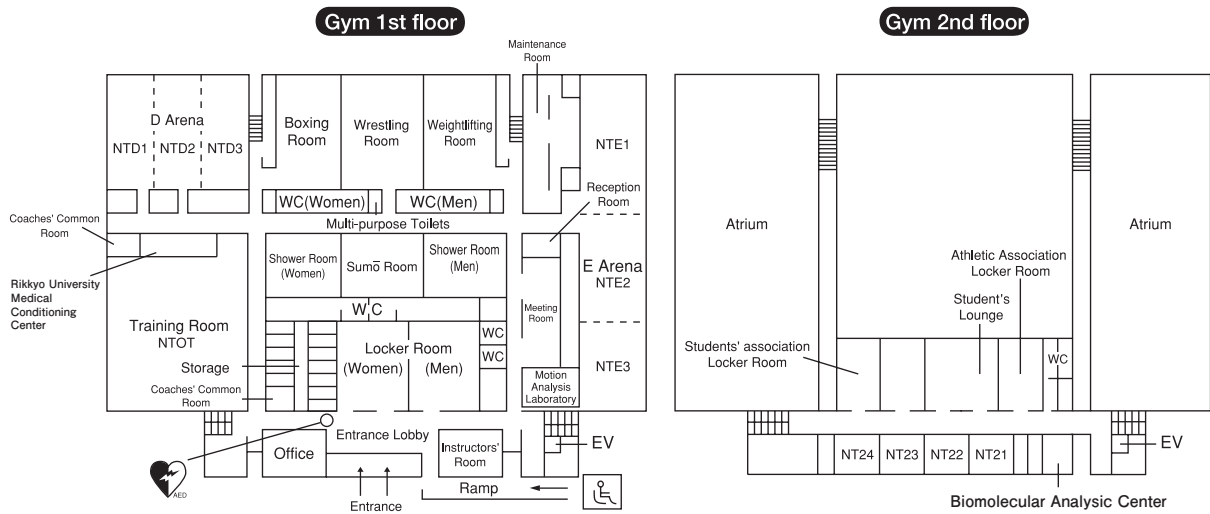

Gym 3rd floor

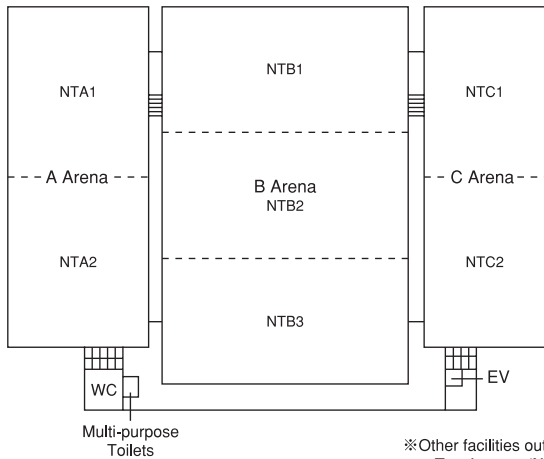

- ※Other facilities outside
- Tennis court (NZA1~6)
 - Multi purpose ground <Ground A> (NZA1·2)
 - Multi purpose court <Court B> (NZB1)
 - St.Paul's Aquatics Center (NPL1·2)
 - St.Paul's Field (NSTD)



A E D Location: Information Lounge (1F, Build. No.1), Reception (1F, Build. No.5), Guard Building, Gymnasium office (1F), Chitokuryo (Baseball Team Dormitory), Yurinoki Hall, St.Paul's Aquatics Center