

Ikebukuro Campus Map

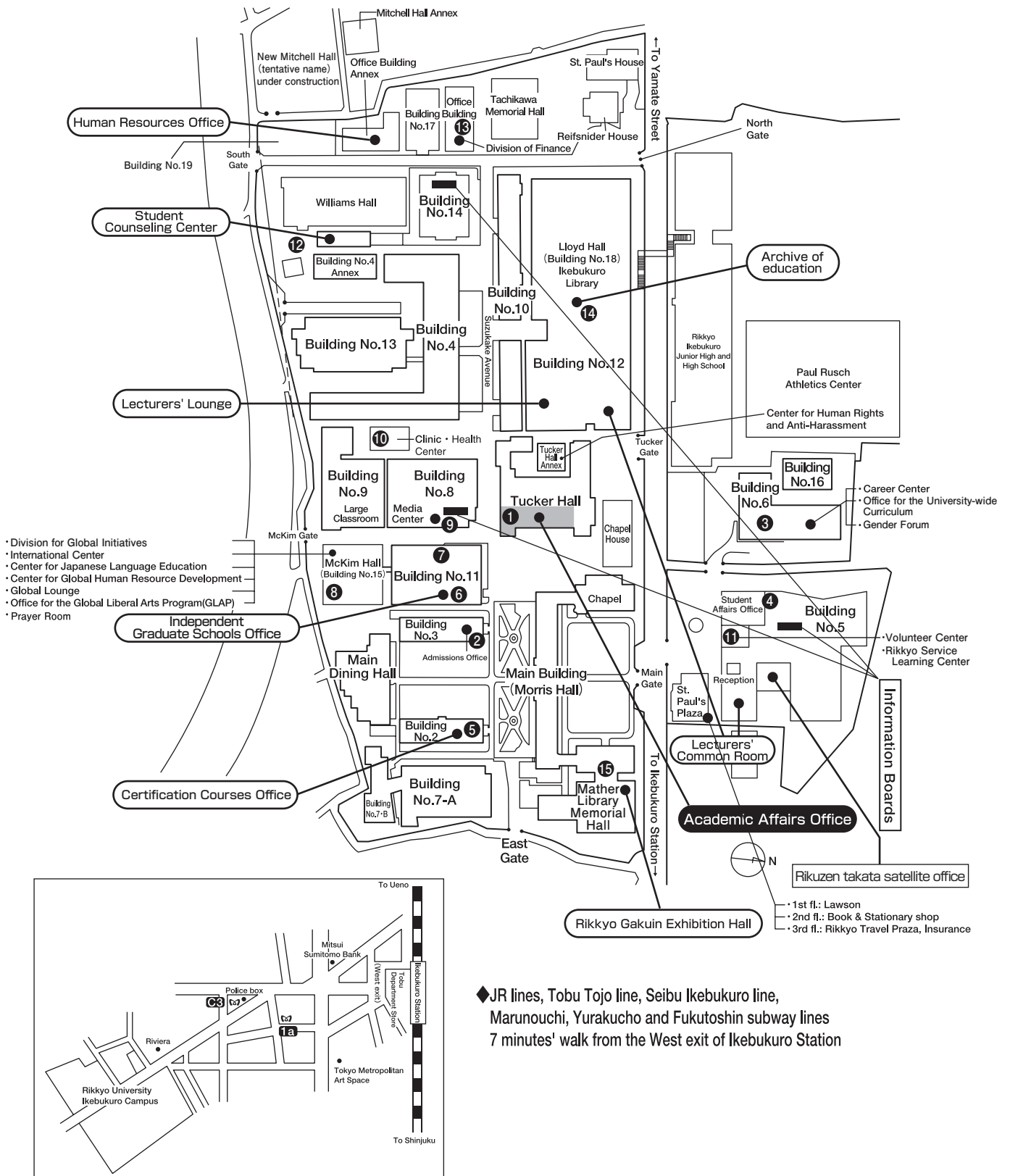

- Division for Global Initiatives
- International Center
- Center for Japanese Language Education
- Center for Global Human Resource Development
- Global Lounge
- Office for the Global Liberal Arts Program (GLAP)
- Prayer Room

- Career Center
- Office for the University-wide Curriculum
- Gender Forum

- Volunteer Center
- Rikkyo Service Learning Center

- 1st fl.: Lawson
- 2nd fl.: Book & Stationary shop
- 3rd fl.: Rikkyo Travel Plaza, Insurance

◆ JR lines, Tobu Tojo line, Seibu Ikebukuro line, Marunouchi, Yurakucho and Fukutoshin subway lines
7 minutes' walk from the West exit of Ikebukuro Station

Ikebukuro Campus Classroom Guide

Main Building

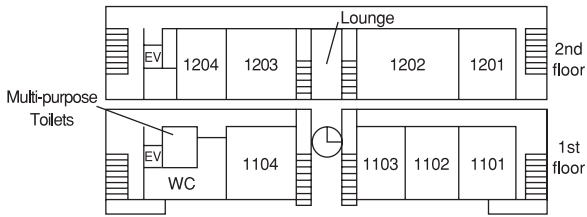

Building No.4

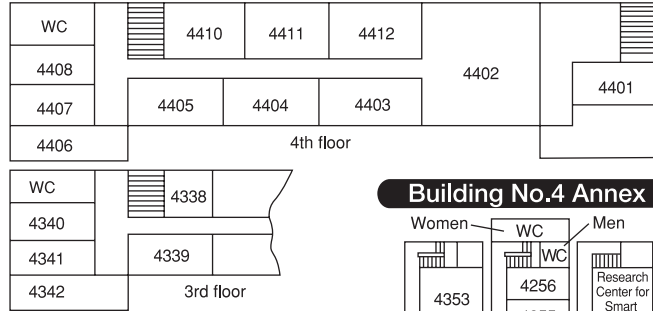

Building No.4 Annex

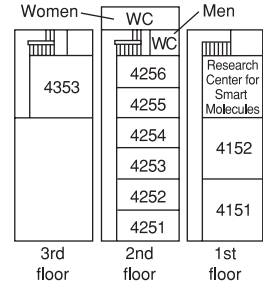

Building No.5

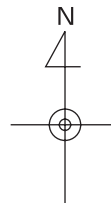
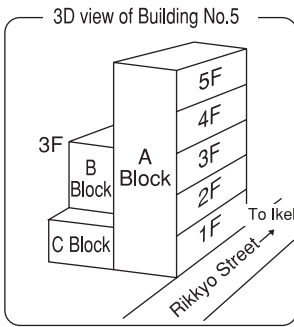
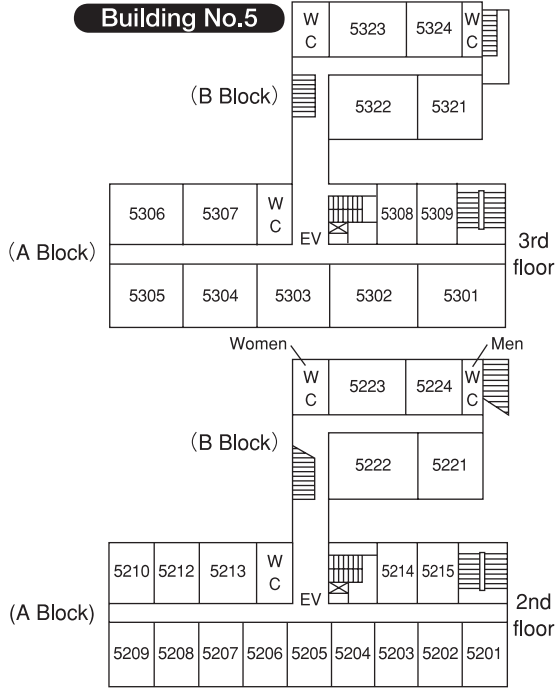

Key to classroom numbers

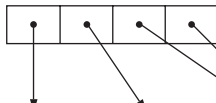

Indicates the building number.
However, 1 ... Main Building
X ... Building No.10
A ... Building No.11
D ... Building No.14
M ... McKim Hall (Building No.15)
P ... Paul Rusch Athletics Center

Indicates the floor.

The number "01" is assigned to the classroom in the southeast corner, with subsequent numbers assigned in a clockwise direction.
Classrooms in Blocks B and C in Building No.5 are numbered in the 20s.

(E.g. 5323 = Building No.5, 3rd floor, Block B)

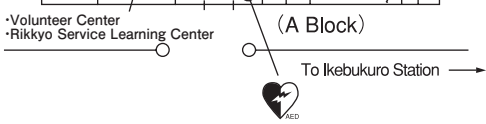
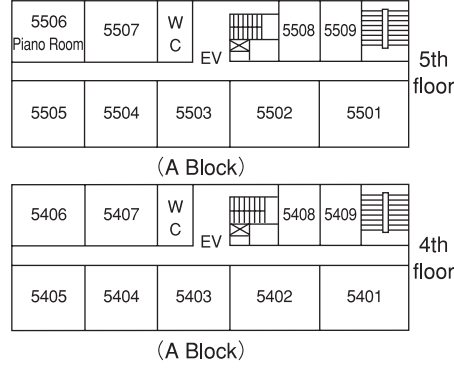
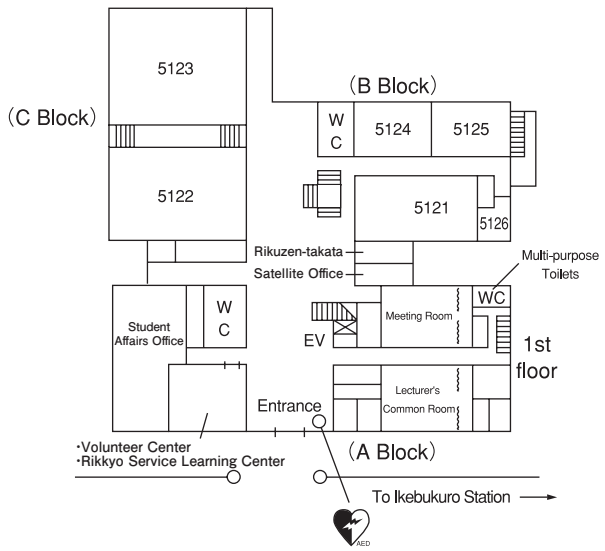

Building No.6

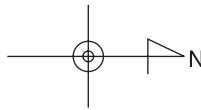
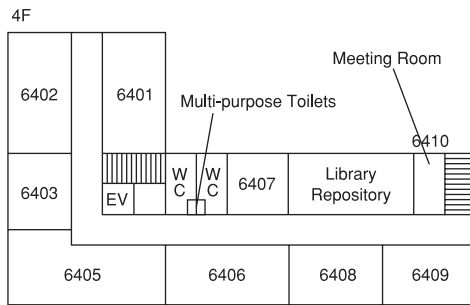
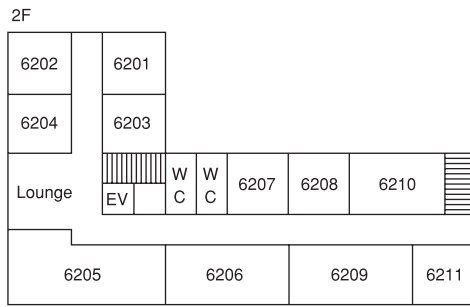
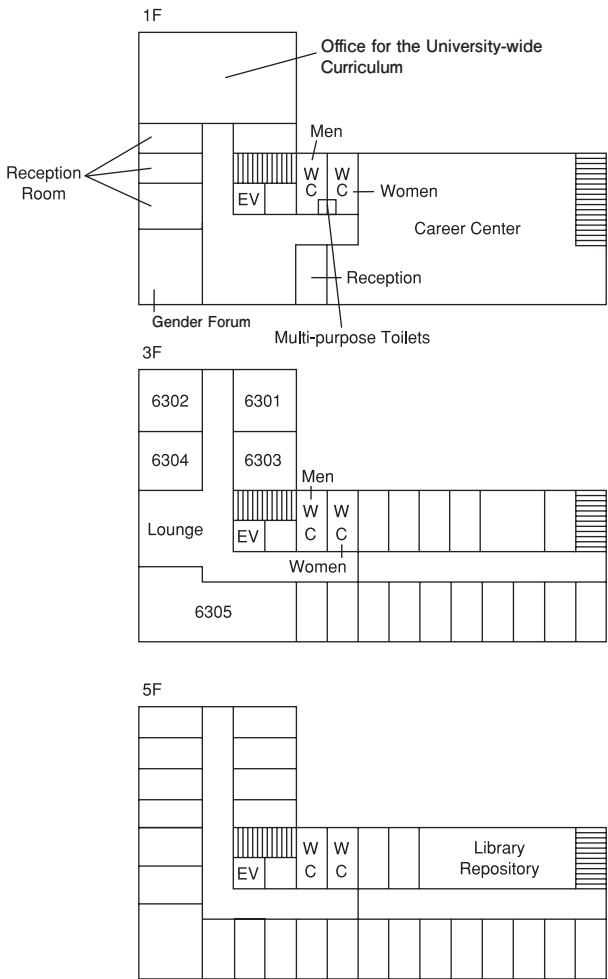

Building No.7

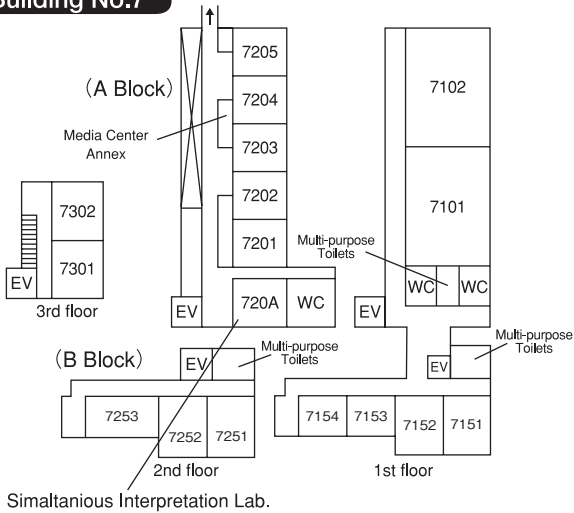

Building No.8

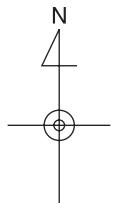
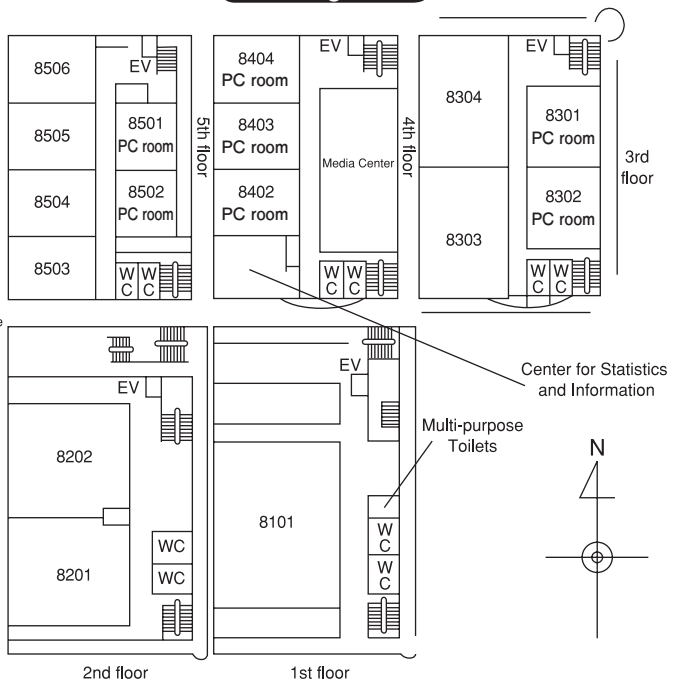

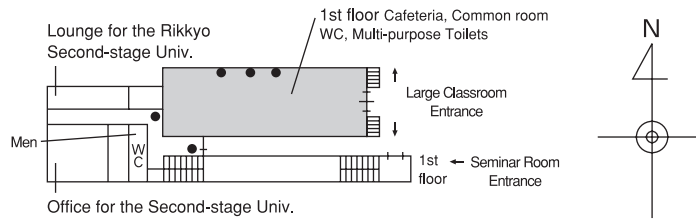
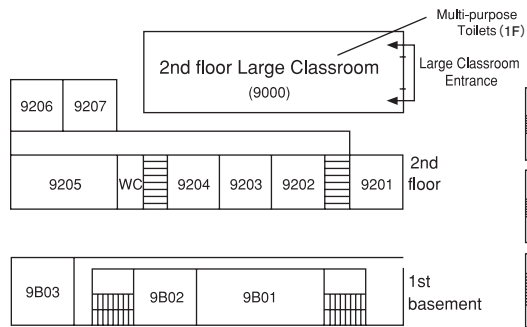
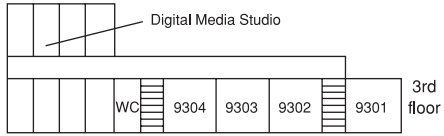
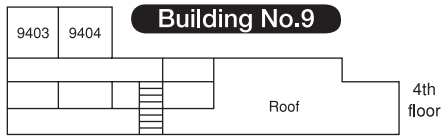

Building No.10

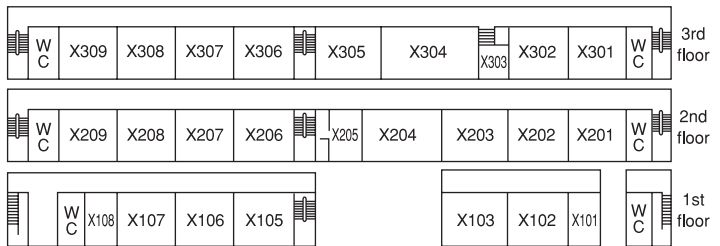

Building No.11

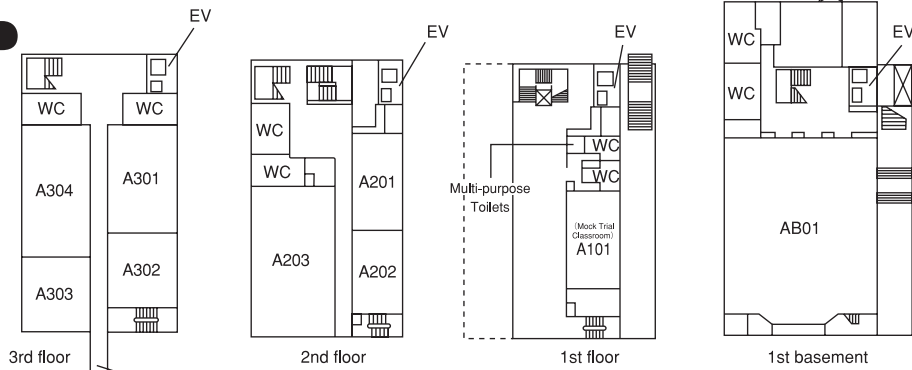

**McKim Hall
(Building No.15)**

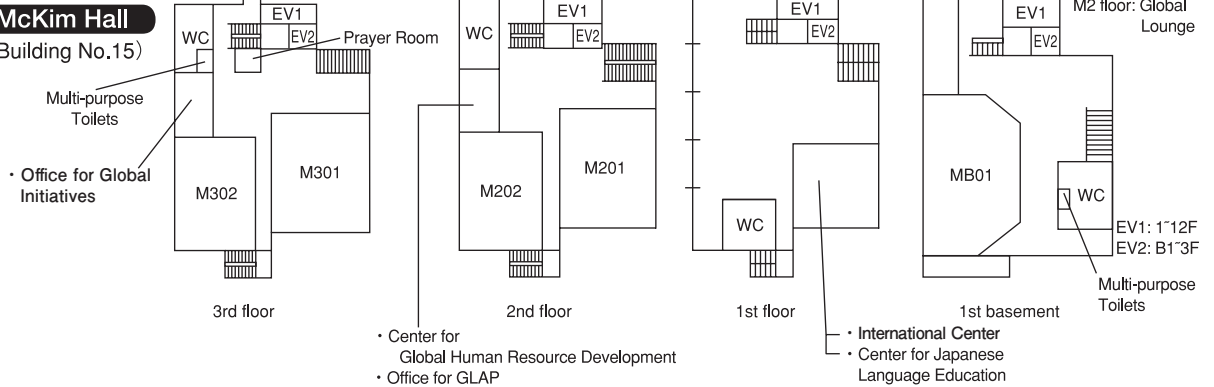

Building No.14

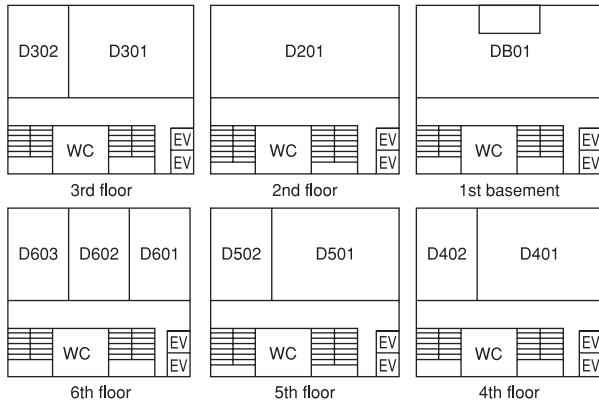

Paul Rusch Athletics Center

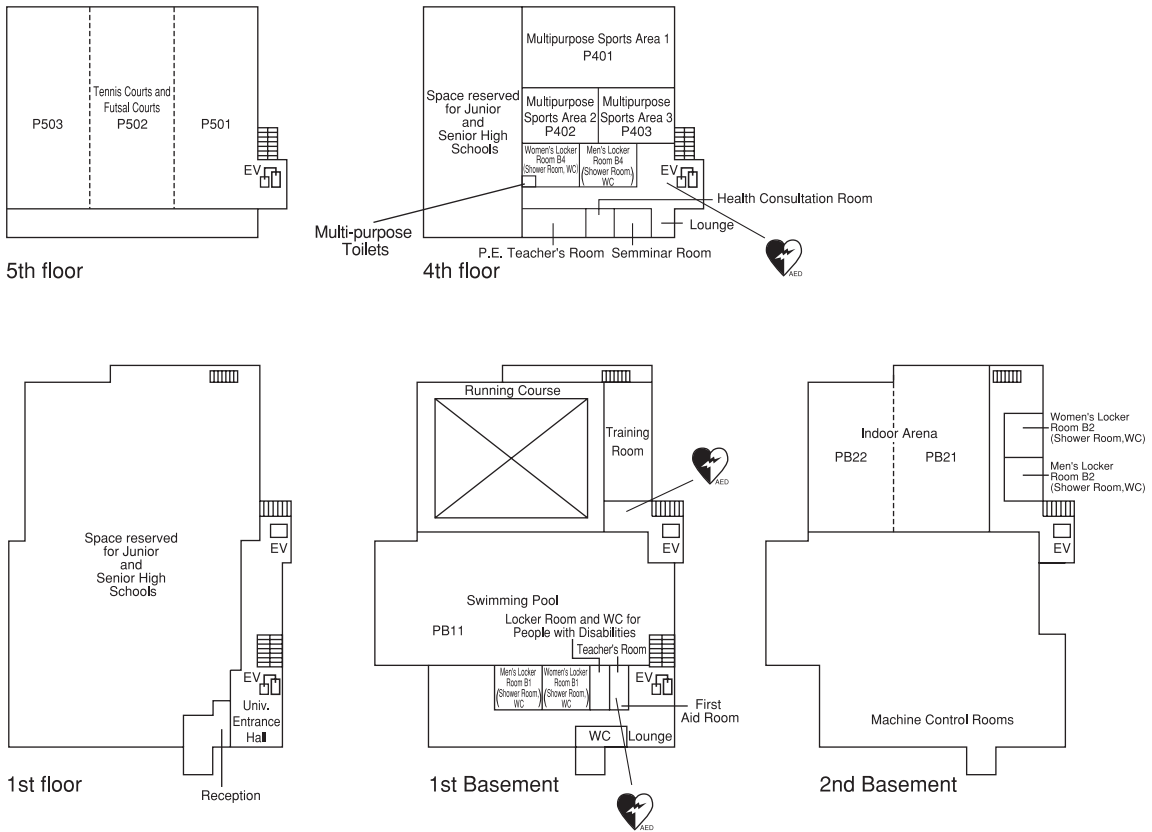

Location: Entrance of Building No.5, Security Office (1F, Building No.12), Paul Rusch Athletics Center
Instructors' Room (B1), Elevator Hall (B1 and 4F)