

# Ikebukuro Campus Map

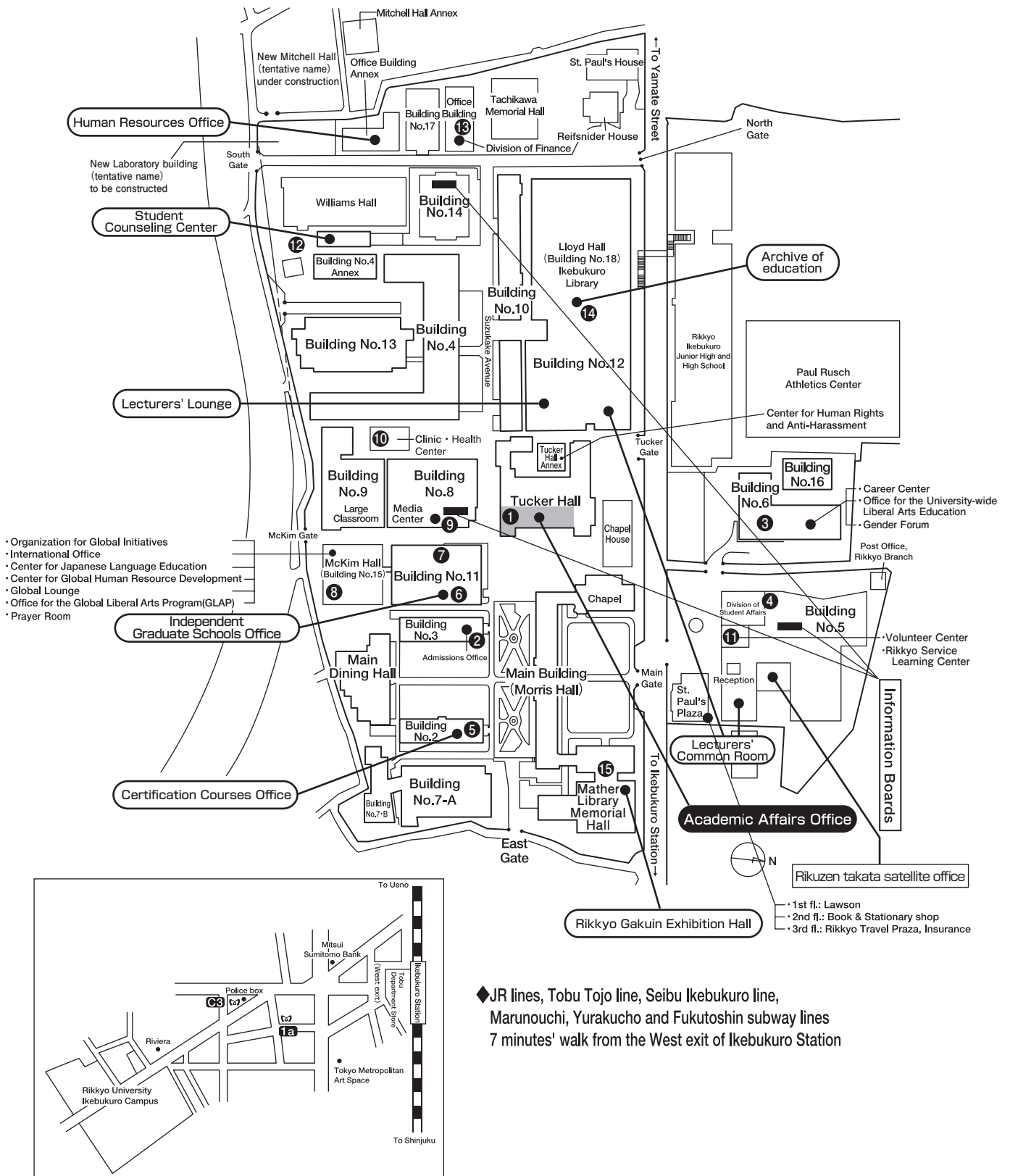

◆ JR lines, Tobu Tojo line, Seibu Ikebukuro line, Marunouchi, Yurakucho and Fukutoshin subway lines  
7 minutes' walk from the West exit of Ikebukuro Station

# Ikebukuro Campus Classroom Guide

## Main Building

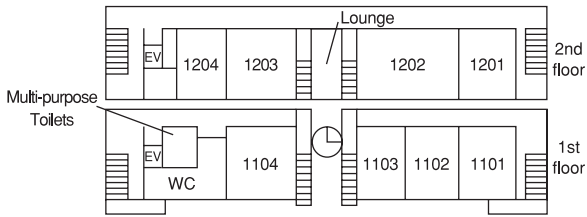

## Building No.4

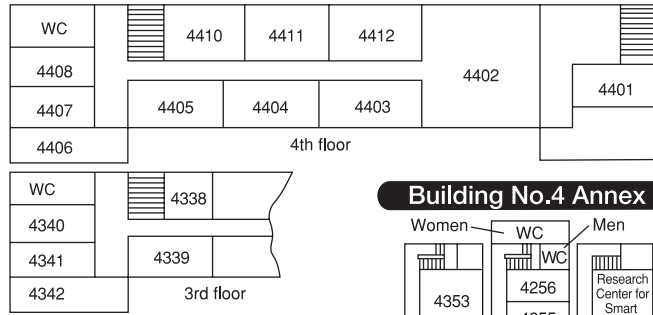

## Building No.4 Annex

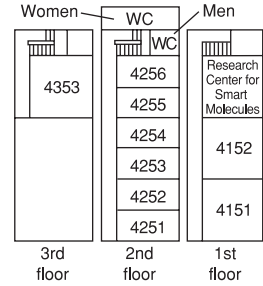

## Building No.5

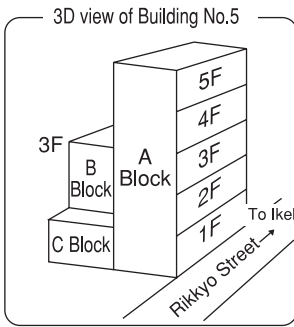
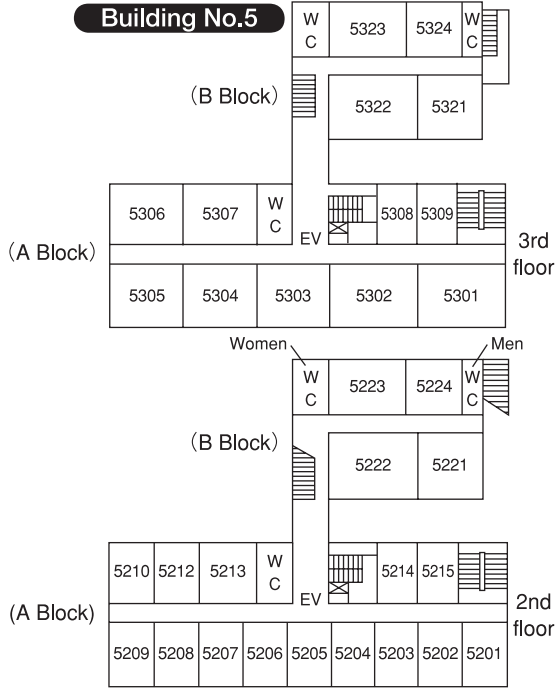

### Key to classroom numbers

Indicates the building number.  
However, 1 ... Main Building  
X ... Building No.10  
A ... Building No.11  
D ... Building No.14  
M ... McKim Hall (Building No.15)  
P ... Paul Rusch Athletics Center

Indicates the floor.

The number "01" is assigned to the classroom in the southeast corner, with subsequent numbers assigned in a clockwise direction.  
Classrooms in Blocks B and C in Building No.5 are numbered in the 20s.

(E.g. 5323 = Building No.5, 3rd floor, Block B)

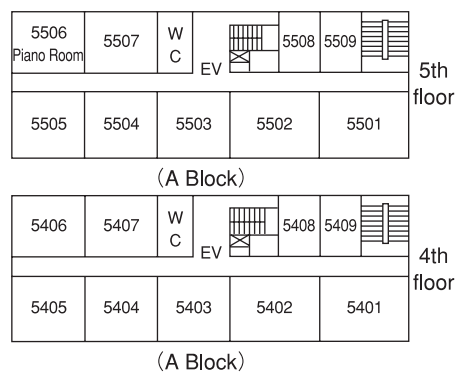
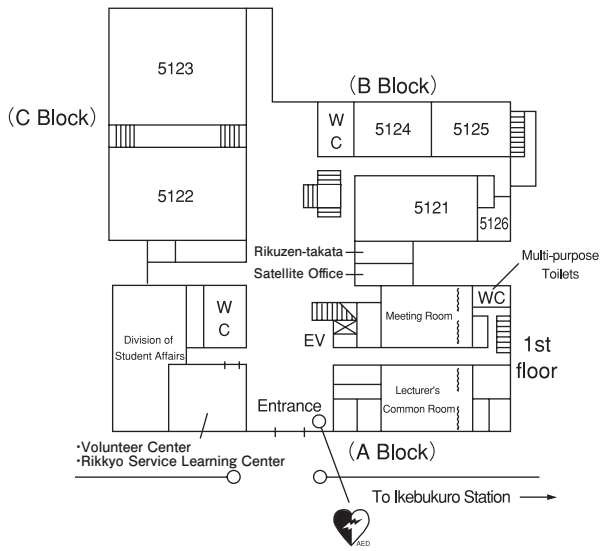

**Building No.6**

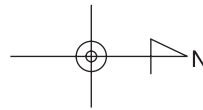
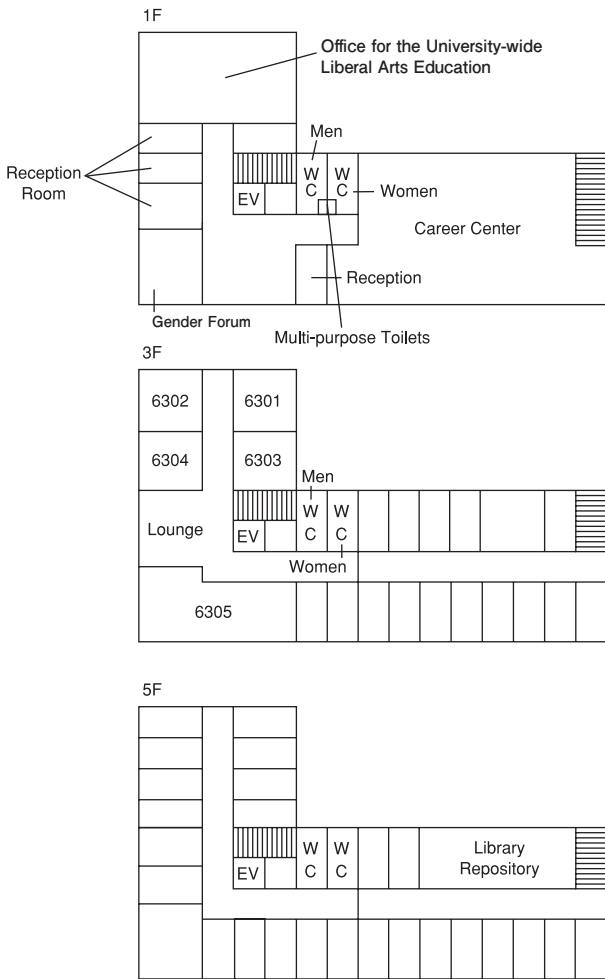

**Building No.7**

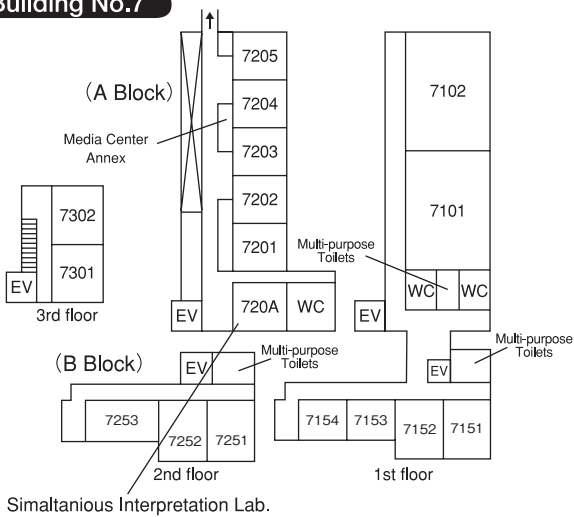

**Building No.8**

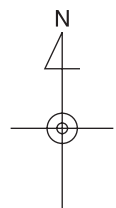
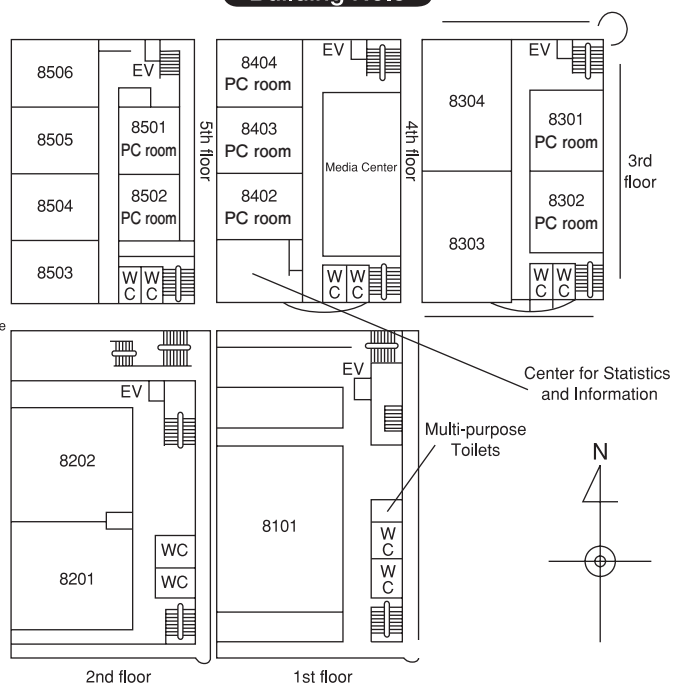

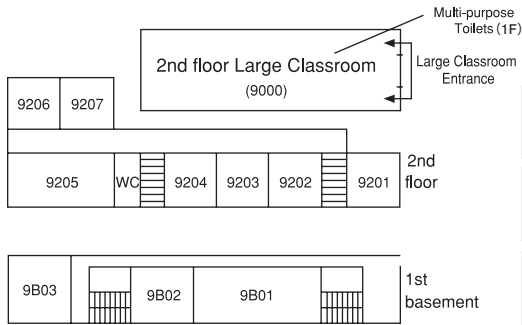
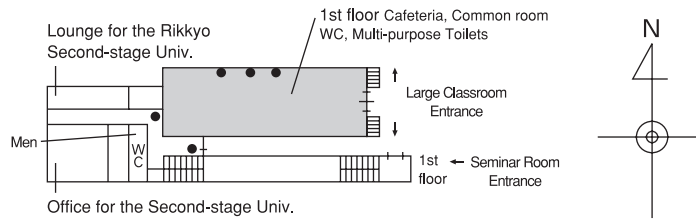
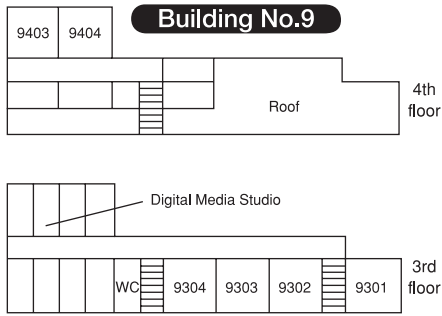

**Building No.10**

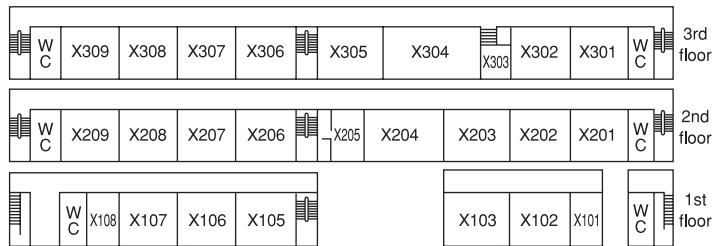

**Building No.11**

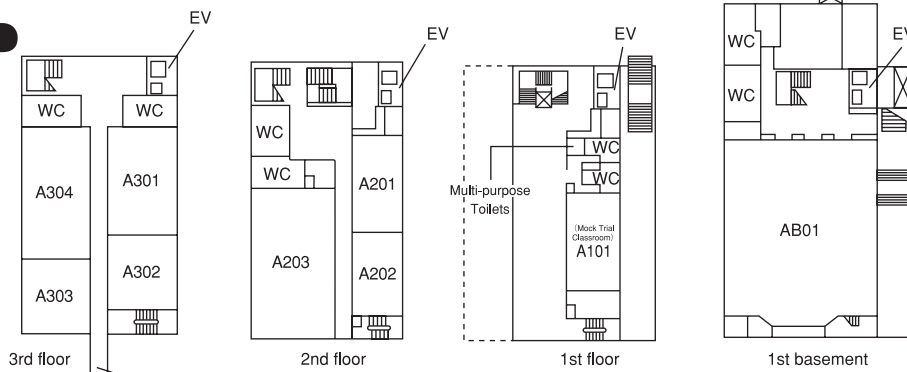

**McKim Hall (Building No.15)**

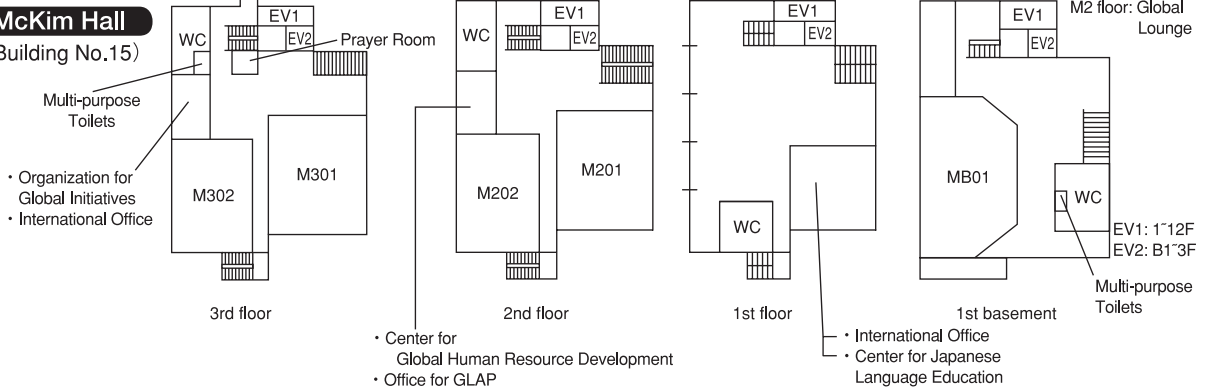

**Building No.14**

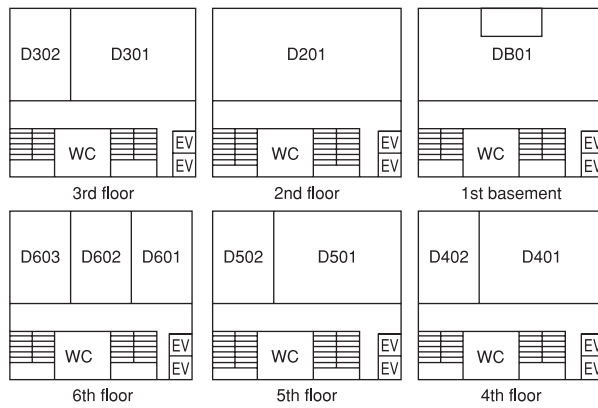

**Paul Rusch Athletics Center**

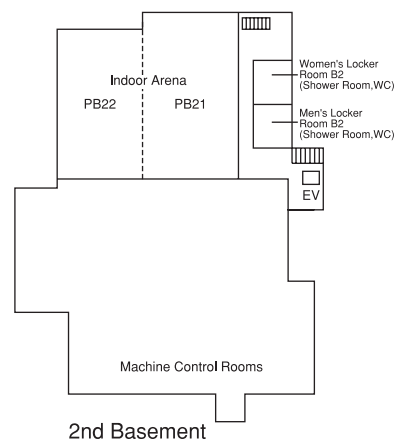
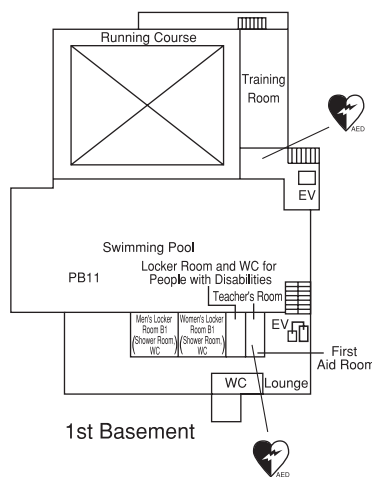
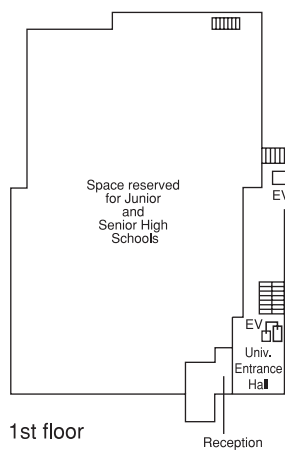
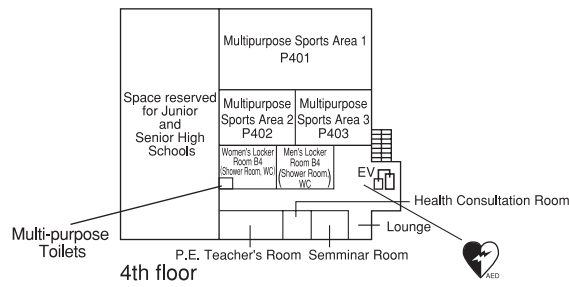
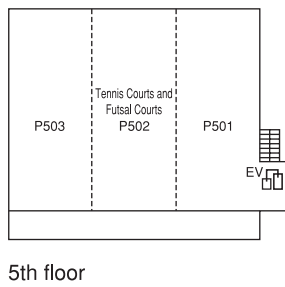

Location: Entrance of Building No.5, Security Office (1F, Building No.12), Paul Rusch Athletics Center  
Instructors' Room (B1), Elevator Hall (B1 and 4F)